

BICC 一层平面图

PLAN OF BICC LEVEL 1

技术说明/TECHNICAL SPECIFICATIONS
地面承重/FLOOR LOADING:
层高/CEILING HEIGHT: 3.4m
特装限高/BOOTH CONSTRUCTION LIMITED: 3m
通道/FREIGHT ENTEANCE: 3.9m(W)*2.4m(H)

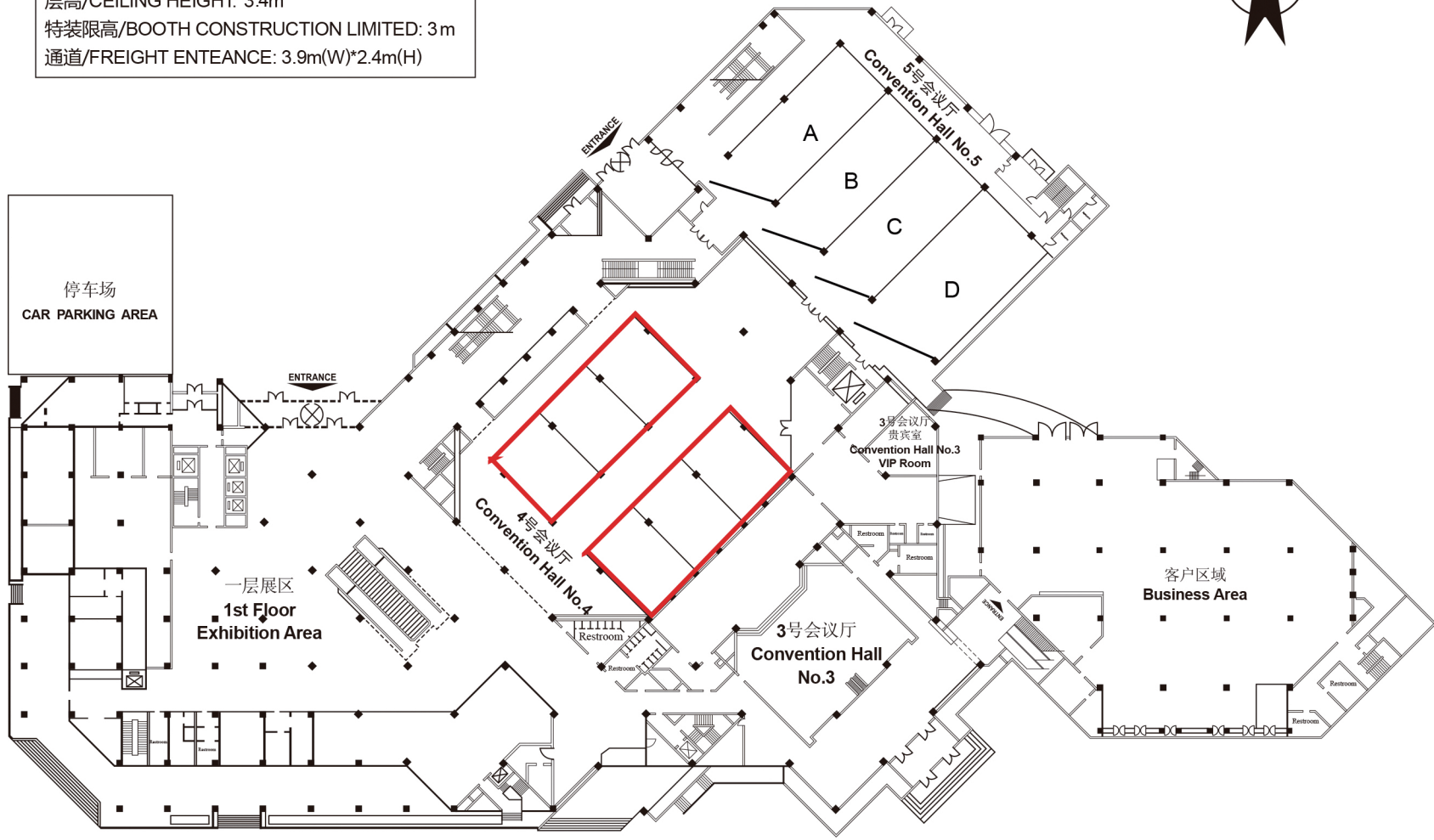

红色区域为展位区

Areas are Marked by Red Rectangles